

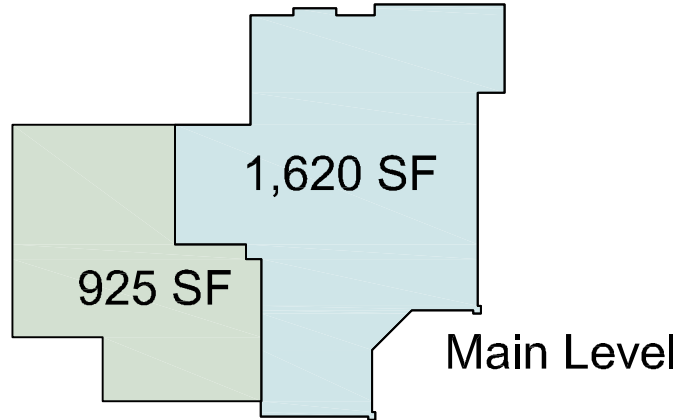

2010 Hollyhock Ct. Longmont, Colorado

Square Footage

1 of 1

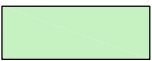

Finished square footage

Main Level	=	1,620 SF	
Upper Level	=	1,937 SF	
Lower Level	=	703 SF	

Total = 4,260 SF

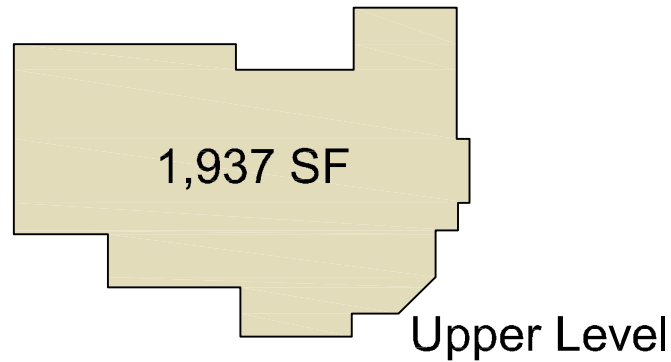

Unfinished square footage

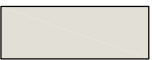
Garage	=	925 SF	
Mechanical	=	835 SF	

Total = 1,760 SF

